

Island Bar / PT (Side)

TRIPLE SINK / PT STATION at SIDE

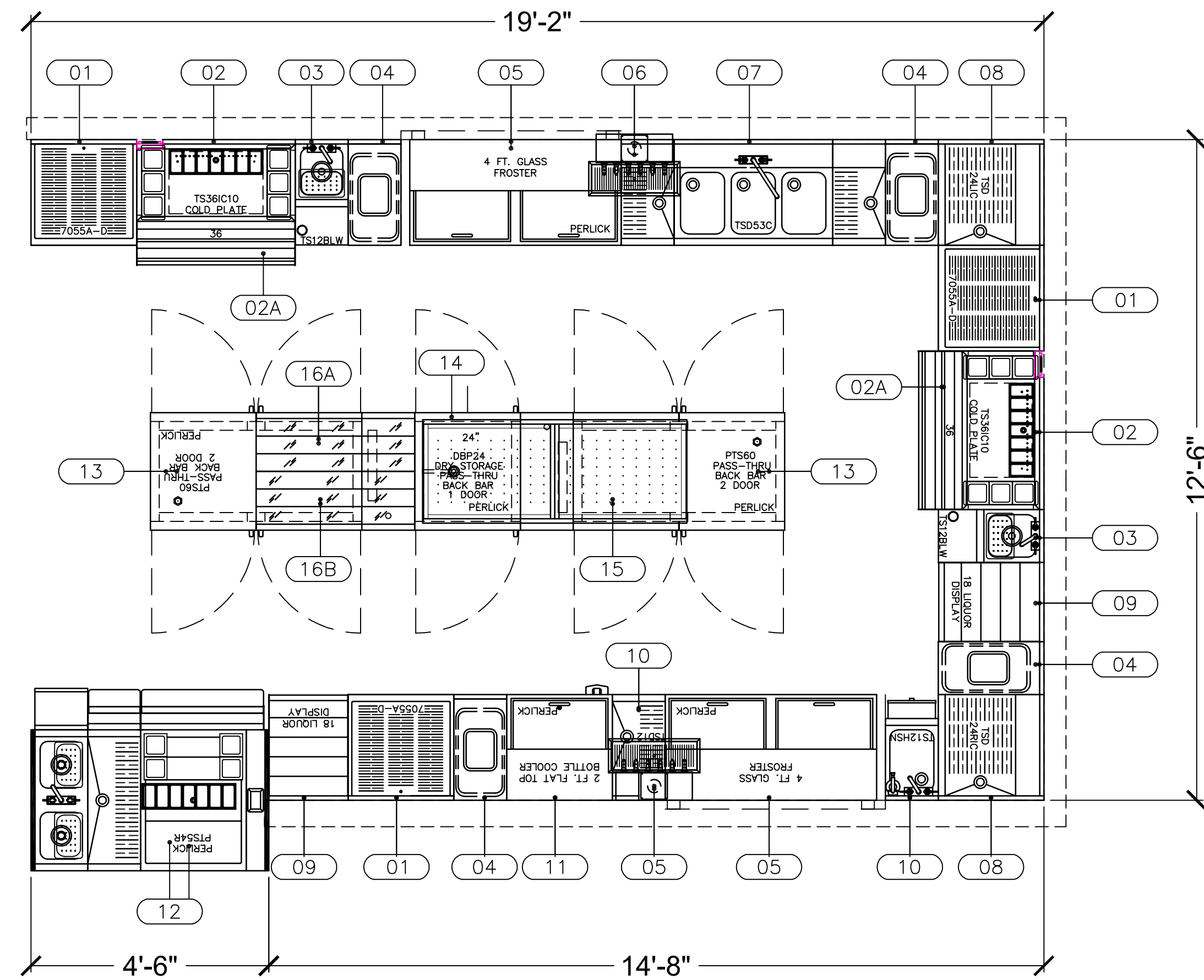

PERLICK EQUIPMENT SCHEDULE															
Item No	Qty	Model Number	Manufacturer	Equipment Category	Equipment Remarks	Volts	Cycle	Phase	Amps	HP	Plug	Perlick AF (in)	Cold Water Size (in)	Hot Water Size (in)	Incl. Drain Size (in)
01	3	7055A-0	Perlick	Underbar Dry Storage											1
02	2	TS36IC10	Perlick	Underbar Ice Chest	7055-265A Chose, BW6-36 Wells, CC7 Tray										0.5
O2A	2	SR-D36	Perlick	Underbar Speed Rail											
03	2	TS12BLW	Perlick	Underbar Blender Station	End Splash (L), 7055-52 Dump Box							18	0.375	0.375	1.5
04	2	TSF12BTB	Perlick	Bridge Trash	Leg Panel (R)										
04	1	TSF12BTB	Perlick	Bridge Trash	Leg Panel (L)										
05	2	FR48	Perlick	Froster/Chiller, Glass/Mug/Plate		115	60	1	6.2	0.33	X				
05	1	4006-6B	Perlick	Dispensing Head, Draft Beer, Tee Tower	C18640A Drain Pan										
06	1	4006-6B	Perlick	Dispensing Head, Draft Beer, Tee Tower	C18640A Drain Pan										
07	1	TS053C	Perlick	Underbar Sink	7055-67A Bev.Chase (L)							0.5	0.5	1.5	
08	1	TS024RRC	Perlick	Underbar Fillers & Drainboards											1.5
08	1	TS024LIC	Perlick	Underbar Fillers & Drainboards											1.5
09	2	TS18LS	Perlick	Underbar Liquor Display	BG18 Guardrails										
10	1	TS12HSN	Perlick	Underbar Handsink								0.375	375	1.5	
10	1	TS012	Perlick	Underbar Fillers & Drainboards	7055-67A Bev.Chase (L)										1.5
11	1	BC24	Perlick	Cooler, Bottle	Opener / Receiver	115	60	1	3.2	0.2	X				1.5
12	1	PT554R	Perlick	Underbar Pass-Thru Service Station	CC7 Cond. Tray								0.5	0.5	0.5
															1.5
13	2	PT560	Perlick	Back Bar Equipment	Adj. Legs 6-7.25"	120	60	1	5.5	0.25	X				
14	1	DBP24	Perlick	Back Bar Equipment	Adj. Legs 6-7.25"										
15	1	GMD524X60	Perlick	Display, Iced	(15") 1390D										0.5
16A	1	LMD3-36R	Perlick	Lighted Merchandise Display		100-240			1.2		X				
									1.5		X				
16B	1	LMD3-36L	Perlick	Lighted Merchandise Display		100-240			1.2		X				
									1.5		X				

- SYMBOLS**
- ⊕ H HOT WATER CONNECTION
 - ⊖ C COLD WATER CONNECTION
 - ⊕ D DRAIN (ICE CHESTS)- 1/2" MALE NPS
 - ⊖ D DRAIN - 1-1/2" MALE NPS
 - ⊕ ELECTRICAL CONNECTION
 - ⊕ DUPLEX OUTLET

I HAVE CHECKED ALL DIMENSIONS AND EQUIPMENT LOCATIONS ON THIS DRAWING FOR ACCURACY:

Approved for fabrication as shown.

Approved for fabrication with changes as noted.

Drawing requires changes as noted; submit revised drawing for my approval.

PLEASE TYPE OR PRINT:

NAME _____ DATE _____

TITLE _____



** DO NOT USE THIS DRAWING FOR CONSTRUCTION SPECIFICATIONS **
 This drawing is provided solely to illustrate the positioning of Perlick Equipment.
 Non-Perlick Equipment or Features which have been copied or derived from other sources are shown on this drawing for reference only.

SCALE: 1/2" = 1'-0"	PROJECT: BAR 11
REV. DATE:	Island w/ Bar Sink & PT (Side)
DRAWN BY: jab	
DATE: 05/10/2016	DRAWING NO.: 1002108
DESIGNED BY:	EXHIBIT NO.: A
REVISED: D	SHEET: 1 of 1
PROPERTY OF THE PERLICK CORP. NOT TO BE COPIED OR USED DETRIMENTAL TO OUR INTERESTS.	