

BACK BAR STEMWARE STORAGE CABINET CUT SHEET DIMENSIONS

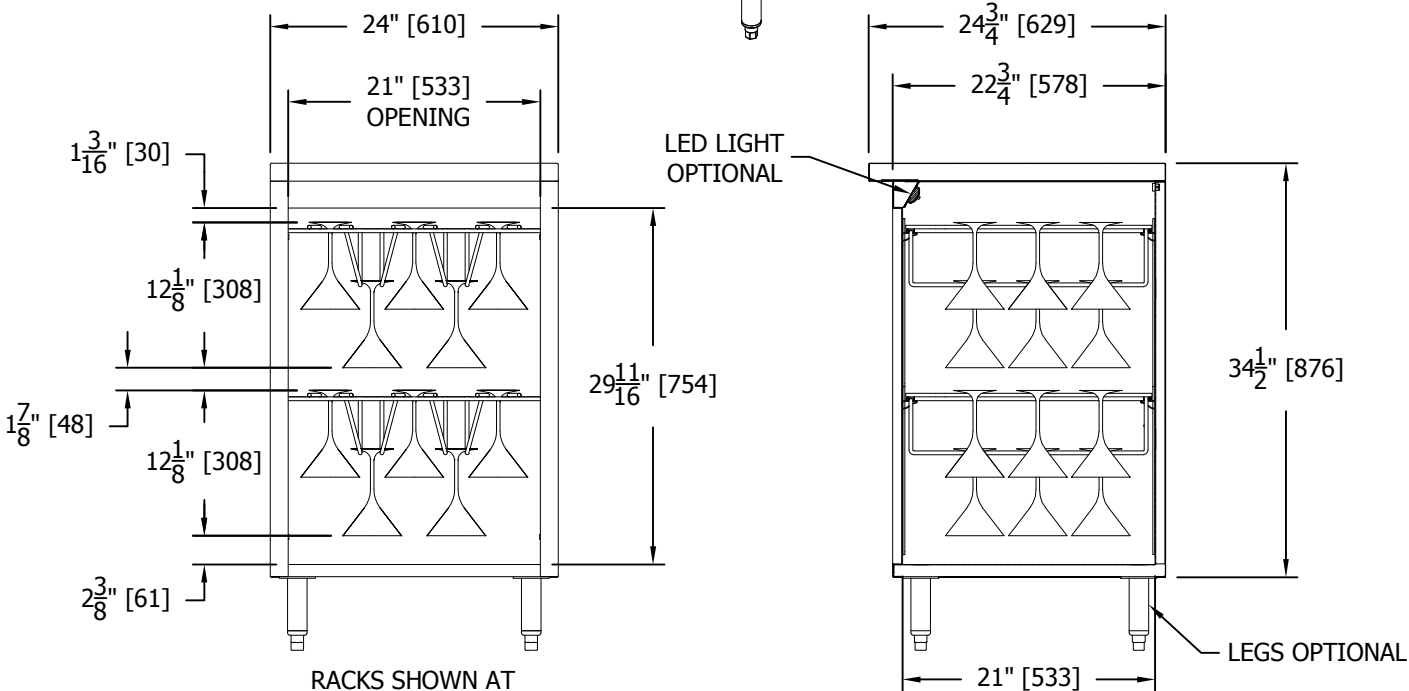

RACKS SHOWN AT
OPTIMAL EQUALLY
SPACED POSITIONS.
RACKS ARE ADJUSTABLE UP
 $\frac{1}{2}$ " INCREMENTS.

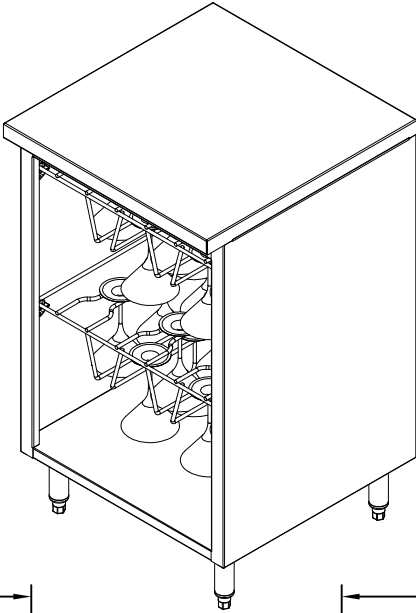
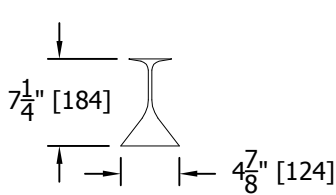

STEMWARE GLASS
REFERENCE

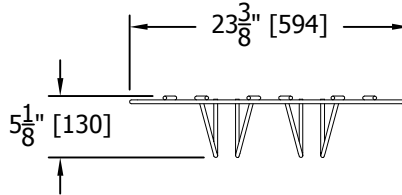

PERLICK CORPORATION
MILWAUKEE, WI 53223

PROPERTY OF THE PERLICK CORP.
NOT TO BE COPIED OR USED DETRIMENTAL TO OUR INTERESTS.

PRINTED
3/18/2013

SCALE: 1:16
DR. JMP DATE: 3/18/2013

95124